

# *AUTOPORE V SERIES*

*MERCURY INTRUSION POROSIMETER*

---

**M I C R O M E R I T I C S**



## *PENETROMETER CLOSURE KIT*

---

950-42805-00

May 2014

---

## ***CONTACT US***

---

### **Micromeritics Instrument Corporation**

4356 Communications Drive

Norcross, GA / USA / 30096-2901

Phone: 1-770-662-3636

Fax: 1-770-662-3696

[www.Micromeritics.com](http://www.Micromeritics.com)

-----

### **U.S. Inquiries**

U.S. Sales Phone: 1-770-662-3636

[USSales@Micromeritics.com](mailto:USSales@Micromeritics.com)

-----

### **Quotes, Orders, and Customer Satisfaction**

Customer Service Phone: 1-770-662-3636

[Orders@Micromeritics.com](mailto:Orders@Micromeritics.com)

-----

### **U.S. Instrument Service Department**

U.S. Service Department Phone: 1-770-662-3666

## ***PENETROMETER CLOSURE KIT***

### ***KIT CONTENTS***

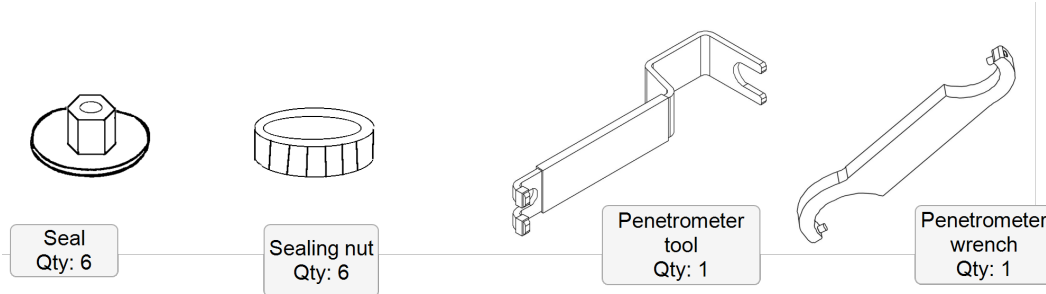

Contact Micromeritics immediately if any items are missing from the kit. Refer to the Parts and Accessories section of the AutoPore Operator Manual for ordering information on replacement parts.

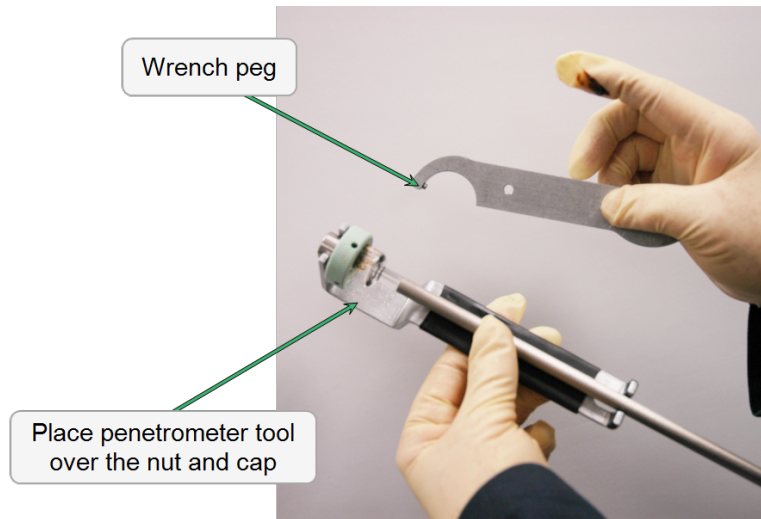

## ***TIGHTEN THE PENETROMETER NUT***

1. Apply grease to the penetrometer bulb and remove any excess grease.
2. Hold the penetrometer upright (sample bulb opening facing upward) and place a seal on the bulb opening.
3. Turn the seal one half turn to smooth the grease and seat the seal.



Take care not to move the seal after seating onto the penetrometer bulb. The grease may extrude too much and cause an air leak.

4. Place the penetrometer tool over the nut.

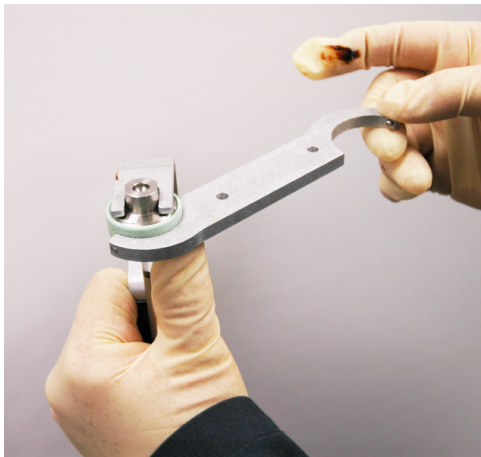

4. Place the wrench peg into a hole in the penetrometer nut. Use the penetrometer tool to stabilize the cap while tightening the nut counter-clockwise.

## ***REMOVE THE PENETROMETER NUT***

If the penetrometer nut cannot be easily opened by hand, it may have become sealed too tightly during analysis. Use the penetrometer wrench to remove it.

1. Place the penetrometer tool over the nut.
2. Place the wrench peg into a hole in the penetrometer nut. Use the penetrometer tool to stabilize the cap while tightening the nut counter-clockwise.
3. Position the wrench so the peg on the wrench fits into the notch on the nut.

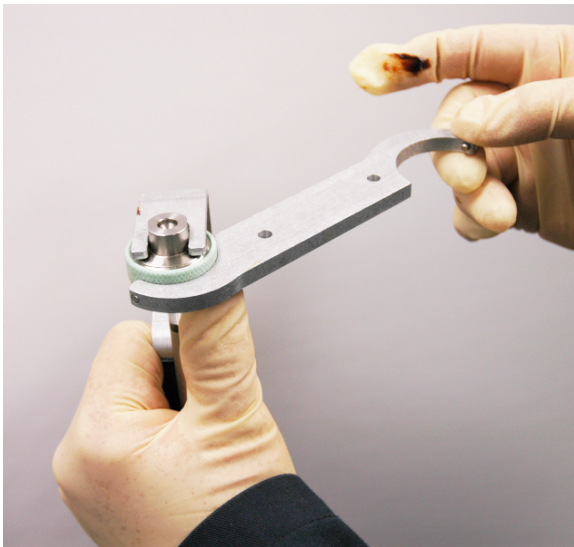

4. While holding the penetrometer tool, turn the wrench clockwise to loosen and remove the nut.